

C:\pwworking\jacobs-emea-01\0410587\B2427722-JAC-HGN-BU_01-DR-CH-0004.dwg - 17/12/2024 07:11:31 - SHEET 01 - Gandhik

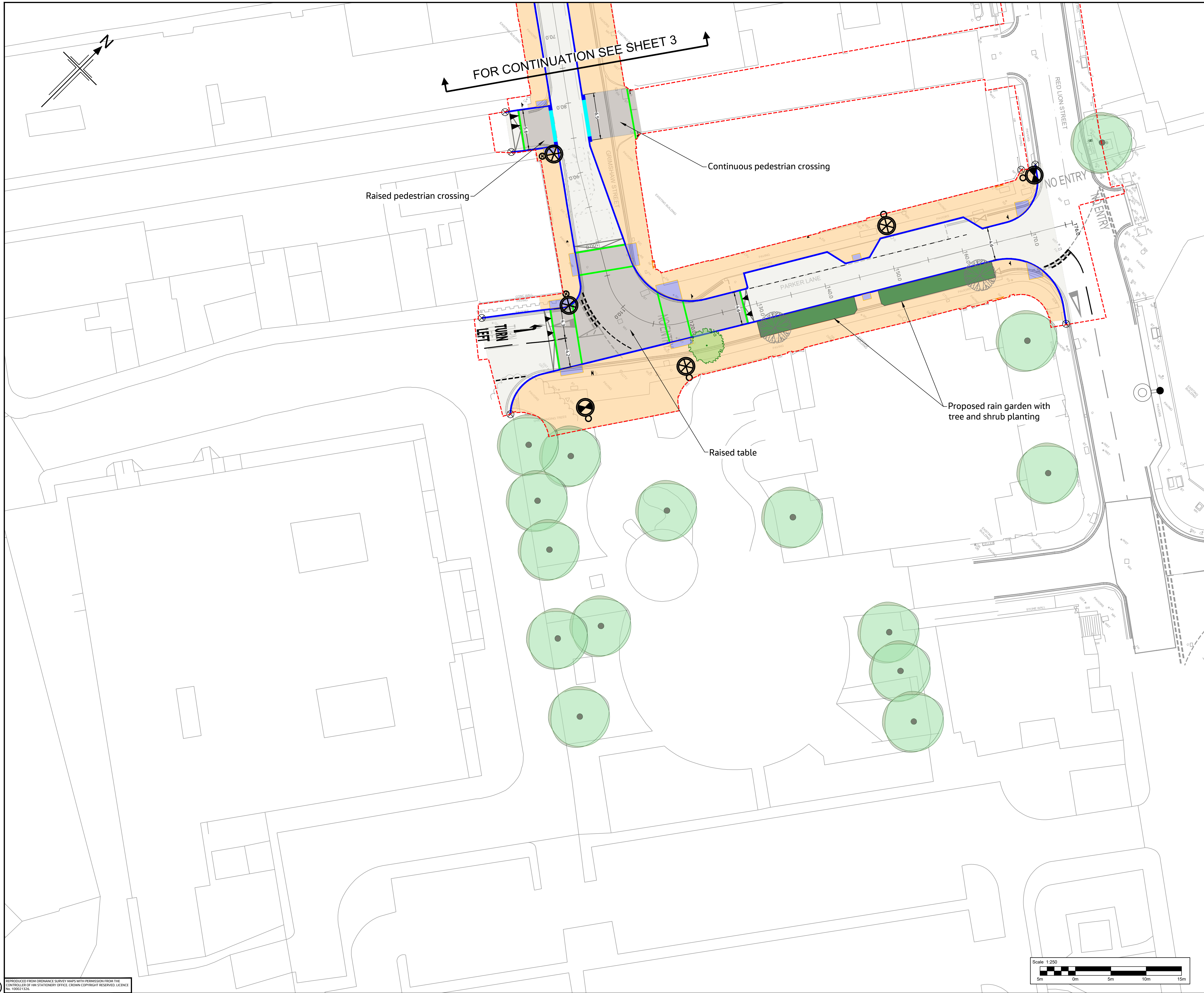

- NOTES:**
- All dimensions in metres unless stated otherwise.
 - Drawings to be printed in colour to enable correct viewing of symbols.
 - Do not scale from this drawing.
 - This drawing is to be read in conjunction with the relevant Manchester Road contract drawings and documents.
 - The Contractor shall verify the presence and location of all services before undertaking any work in any area of the site by carrying out a full non-intrusive survey of the entire site before commencing the works.
- KEY:**
- | | |
|--------------------------------------|----------------------------|
| --- Scheme Boundary | --- Granite kerb |
| --- Tactile Paving - Uncontrolled | --- Dutch kerb |
| --- Tactile Paving - Controlled | --- Flush carriageway kerb |
| --- Tactile Paving - Corduroy | --- Splay kerb |
| --- Carriageway | --- Flush metal edge |
| --- Footway | --- Edging Kerb |
| --- Raised carriageway | ⊗ Tie into existing |
| --- Natural stone paving | ⊣ Traffic sign |
| --- Natural stone raised carriageway | == Road markings |
| --- Off-street bay | --- Street name plate |
| --- Bus stop paving | SB Sign bollard |
| --- Red coloured surfacing | --- Guardrail |
| ⊙ Lighting column (various) | ⬆ Ramp |
| ⊣ Feeder BT | ⬆ Pex Existing planter |
| ⊣ Feeder pillar | ⬆ B1 Bench |
| ⊣ Cabinet | ⬆ BL Bollard |
| ⬆ Traffic signal head and pole | ⬆ JCS Cycle stand |
| ⬆ Existing grass retained | ⬆ LBL Litter bin |
| ⬆ Ornamental planting | ⬆ TG Tree grille |
| ⬆ Rain garden | ⬆ Bus shelter |
| ⬆ Existing trees | ⬆ Bus flag pole |
| ⬆ Proposed tree in soft landscape | |
| ⬆ Proposed tree in hard landscape | |

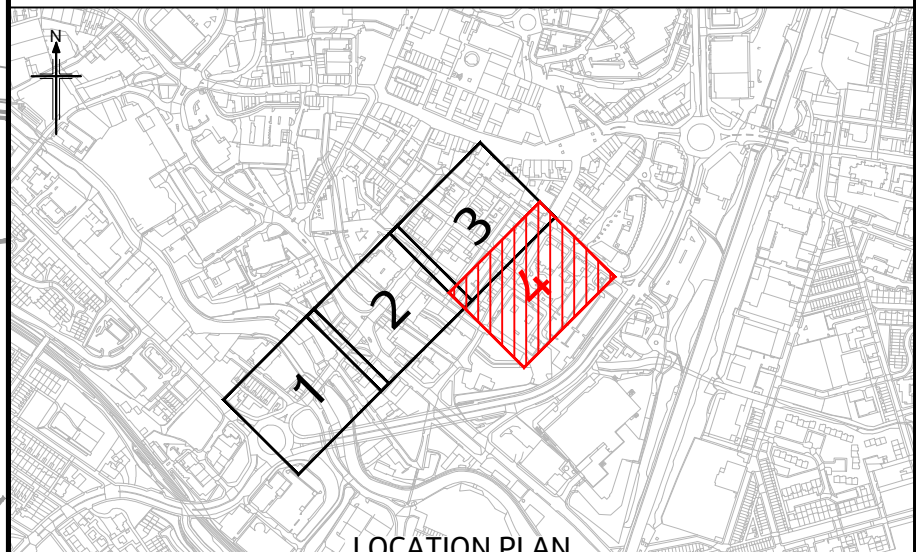

LOCATION PLAN							
P01	06/09/24	SUITABLE FOR COSTING	KG	JK	CM	PB	
P02	01/10/24	SUITABLE FOR REVIEW & COMMENT	KG	JK	CM	PB	
P03	16/12/24	SUITABLE FOR TENDER	KG	JK	CM	PB	
Rev	Rev. Date	Purpose of revision	Drawn	Checked	Rev'd	Appr'd	

Jacobs
7th Floor, 2 Colmore Square, 38 Colmore Circus
Queensway, Birmingham, B4 6BN
Tel: +44(0)121 237 4000 www.jacobs.com

Client
Lancashire
County Council

Project
LUF Detailed Design

Drawing title
**MANCHESTER ROAD
GENERAL ARRANGEMENT
SHEET 4 OF 4**

Drawing status
D2 - SUITABLE FOR TENDER

Scale	1:250	DO NOT SCALE
Jacobs No.	B2427722	
Client no.	B2427722	

Drawing number	B2427722-JAC-HGN-BU_01-DR-CH-0004	Rev	P03
----------------	-----------------------------------	-----	-----

© Copyright 2024 Jacobs U.K. Limited. The concepts and information contained in this document are the property of Jacobs. Use or copying of this document in whole or in part without the written permission of Jacobs constitutes an infringement of copyright. Limitation: This drawing has been prepared on behalf of, and for the exclusive use of Jacobs Client, and is subject to, and issued in accordance with, the provisions of the contract between Jacobs and the Client. Jacobs accepts no liability or responsibility whatsoever for, or in respect of, any use of, or reliance upon, this drawing by any third party.